



MARIE VILLAGE

AN ASGi HOMES NEIGHBORHOOD

Plan 903

- 903 sq. ft.
 - 1 Bedroom Loft
 - 1 Bathroom
 - Utility Closet
 - Gourmet Kitchen with Large Island
 - Dishwasher Included
 - Living Room and Dining Area adjacent
 - Large Front Porch Area
- Optional:
- Kitchen Window

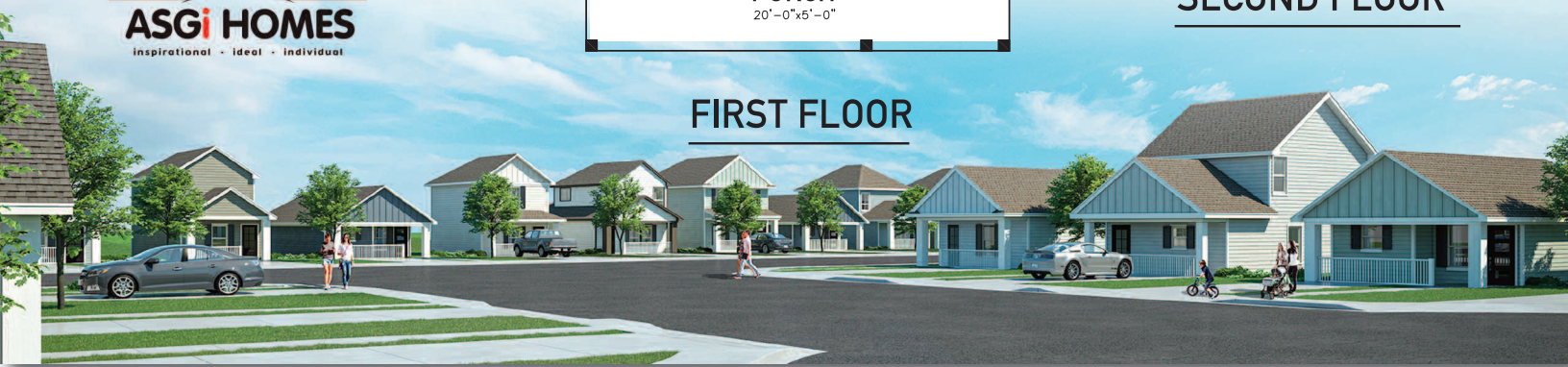
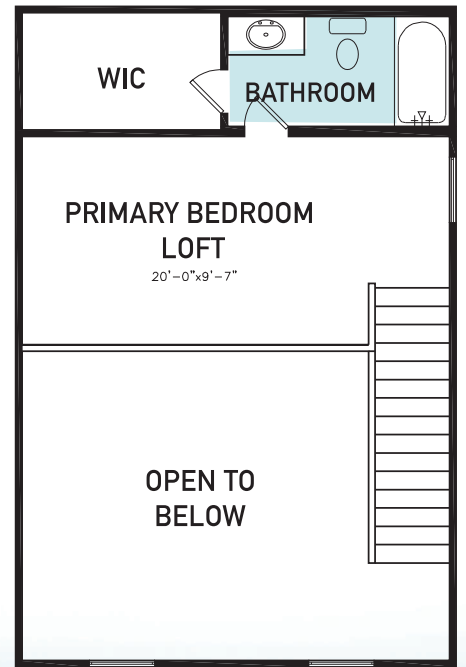

ASGiHOMES.com

Let's get Social



©Apr., 2023 ASGi Homes. All rights reserved. Specifications are subject to change without notice. Elevations may vary. Square footages and room sizes area approximate. All information (including, but not limited to prices, availability, incentives, floor plans, site plans, features, standards and options, assessments and fees, planned amenities, programs, conceptual artists' renderings and community development plans) is not guaranteed and remains subject to change or delay without notice. Maps and plans are not to scale and all dimensions are approximate. Please see an ASGi Homes sales associate for details. 4/23

